

ICU OFF CAMPUS HOUSING GUIDE

2016 April ICU Service., Co. Ltd.

WELCOME to ICU! Renting an apartment in Japan, you may need to have a minimum of 2 years contacts and requiring a guarantor, also to arrange the utilities by yourself. Avoiding these hustles, we recommend to have easy way to find an accommodation!

The agencies we introduce here are fairly easy to contact, as their services include:

- Utilities (Gas, Electricity, Heats/ at cost or free).
- Internet (WiFi or Ethernet / at cost or free).
- Minimum Furniture (i.e. Desk & Chair, Microwaves, etc)
- Guarantor not required.

¥ ¥ ¥ You can save a lot of time and initial costs! ¥ ¥ ¥

Contact the agents listed below directly!

Question? Contact us at:

ICU Service Co., Ltd.

(2/F Admin. Bldg., ICU)

info@icu-service.com

Tel: +81(0)422.33.3530

Weekday 9:00-17:00 JST

www.icu-service.com



Agents	¥	Utilities	Inter net	Meals	Term	Privacy	Notes
1. OAK HOUSE	¥ ¥	○	○ WiFi ether- net	×	Min. 1 mth~	△ Shared bathroom /kitchen	Type of Property: Share Houses Variety of shared spaces are available (i.e. Theater, Gym, etc) 40-60% of residents are non-Japanese.
2 Leo palace21	¥ ¥ ¥ ¥	△ @ cost	△ ether- net at cost	×	Min. 1 mth~	○ Private bathroom /kitchen	Type of Property: Apartments Utilities(Some are at cost; some are included. Depends on the plan you choose)
3 Kyoritsu Maintenance	¥ ¥ ¥	△ @ cost	○ ether- net	○ BF+DN	Min. 1 day~	△ Shared bathroom /kitchen	Type of Property: Dormitory type On-site dormitory manager available. Avg. 20% of residents are non-Japanese.

A NEW RENTAL STYLE FOR A NEW ERA! OAKHOUSE SHARE HOUSES ARE FUN, AFFORDABLE, AND RELIABLE!

1

SOCIAL RESIDENCE HIGASHI-KOGANEI



Since I started living here my life has turned around 180 degrees." The words of one of our female residents. She was able to gain a new appreciation for life. This share house has 160 people and is near a forest. With a relaxed mood- the house is 8min from Kichijoji- 21min from Shinjuku. There is an outdoor sports court for futsal- tennis- or other fun sports. Inside there is a studio where you can do dance- yoga- table tennis- and billiards. Here you can take part in many activities and make new friends- learn- and find a new you. So why not come change your life at Higashi-Koganei?

¥56,000

CONDO FEE: ¥12,000

ELECTRICITY, GAS, AND WATER FEES ARE INCLUDED IN THE CONDO FEE.

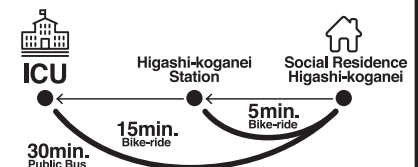

1

**KEY MONEY
AGENCY FEE
SECURITY DEPOSIT**

0 YEN

*A 30,000-yen management fee is required only for the 1st month.

2

**FURNISHING
REFRIGERATOR**

INCLUDED

*Each room is equipped with a desk, chair, bed, and refrigerator.

3

**PLENTIFUL
SHARED
FACILITIES**

**SOUND STUDIO
FITNESS GYM
THEATER**

*Shared facilities may differ between houses.

OAKHOUSE

Shibuya Information Center ☎ +81(0)3.6427.3777

150-0002 Monostep bldg. 3F, 3-15-4 Shibuya, Shibuya ward, Tokyo

E-mail : info@oakhouse.jp / BUSINESS HOUR : 10:00~18:00





Need your own private space?

Furnished Room with Utilities

You can save a lot in initial expenses!

Leopalace21

2 types of rental plans are available to meet your needs!

Staying for more than a year? Choose...

CHINTAI Contract

- Minimum Rental Term: 2 years
(The term can be shorten with fee, please consult)

Staying for less than a year? Choose...

Short-Term Contract

- Minimum Rental Term: 1 month

Our Apartments offer...



- Desk and Chairs, TV, Washing Machines, Microwaves, AC, Refrigerators
- High-tech home security system
- Internet Service (at cost; Ethernet)
- "Customize your room" service.
(one can choose the wall paper design)



Leopalace21

Leopalace Center Kichijoji URL: <http://en.leopalace21.com/>

TEL: +81(0)422-20-0420 FAX: +81(0)422-20-0429

2/F Rainbow Bldg., 1-9-10 Kichijoji-Honcho, Musashino-Shi, Tokyo



Breakfast & Dinner Included! Only 15min bicycle ride from ICU!
Our high quality student dormitories offer safety, convenience, and privacy!

Men	Dormy Higashi Koganei 2	Type A
	Address	2-6-30 Kajino-cho, Higashikonagei-shi Tokyo-to
	Access	about 13 min walk from Higashi Koganei station on JR Chuo Line
	Structure	2-story steel construction
	Room	western room 13.77m ² Capacity: 46 people
	* Accessible in about 15 min to ICU by bicycle	

Women	Dormy Fuchushiraitodai	Type A
	Address	4-51-13 Shiraitodai, Fuchu-shi, Tokyo-to
	Access	about 3 min walk from Musashinodai station on Keio line, about 10 min walk from Shiraitodai station on Seibu Tamagawa line
	Structure	5-story reinforced concrete construction
	Room	Western room 13.16 m ² Capacity: 148 people
	* Accessible in about 16 min to ICU by bicycle	

Sample Layout

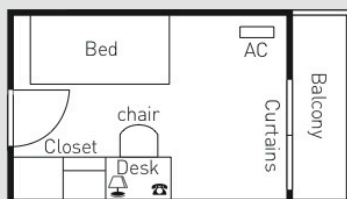

Initial Cost 1			
Deposit	Tax-free	50,000 yen	All Types
Entrance Fee	Tax-free	50,000 yen	
Building Maintenance Fee	Tax-free	3,000 yen	

Initial Cost 1			
Room Cleaning Fee	Tax	33,000 yen	Type A
		43,000 yen	Type C

※Rent, electricity and internet facility fee need to be paid in advance. ※Facility and equipment in rooms vary slightly depending on the building.

Monthly Cost			
Rent	Free meals	Tax-free	Payment in advance
			62,500 yen
Electricity Fee		Tax	Payment in advance
			Basic rate 5,000 yen (Fixed rate) ※Direct contract with the power company in some buildings
Internet facility Fee		Tax	Payment in advance
			3,602 yen (Fixed rate)
Call Charge		Tax	Later payment
			Calculated according to use

We also have rooms available at popular Kichijoji area! Check our website for more details!

Applications and Inquiries

Kyoritsu Maintenance Co Ltd Gakuseikaikan Office Toll free 0120-88-1030 (Japan Only)

2-18-8 Sotokanda, Chiyoda-ku, Tokyo-to 101-8621 TEL:+81-3-5295-7791 FAX: +81-3-5295-5906

Application from the Internet

<http://www.gakuseikaikan.com/>

Kyoritsu Gakuseikaikan



Guarantor not required.